

# ACPMGM-050 Series Synchronous Gearmotors



## FEATURES

- AC Synchronous Gearmotors
- Designed for High Volume Applications
- Up to 416 oz-in. of Torque
- 7 Watt
- 60 Hz
- 50mm Motor Body Diameter
- Custom Versions are Available for OEM Applications



## DESCRIPTION

Anaheim Automation's ACPMGM-050 Series AC Gearmotors come in a variety of input voltages and related torques/speeds. Anaheim Automation's ACPMGM-050 AC Synchronous Gearmotors are ideal for applications that require a constant speed while connecting to the AC power line voltage. Custom options for the Single Phase AC motor line include optimizing the maximum speed, torque, current, voltage, cabling, wiring, connectors, and shaft modifications.

\* Note: Capacitors not included

## DIMENSION

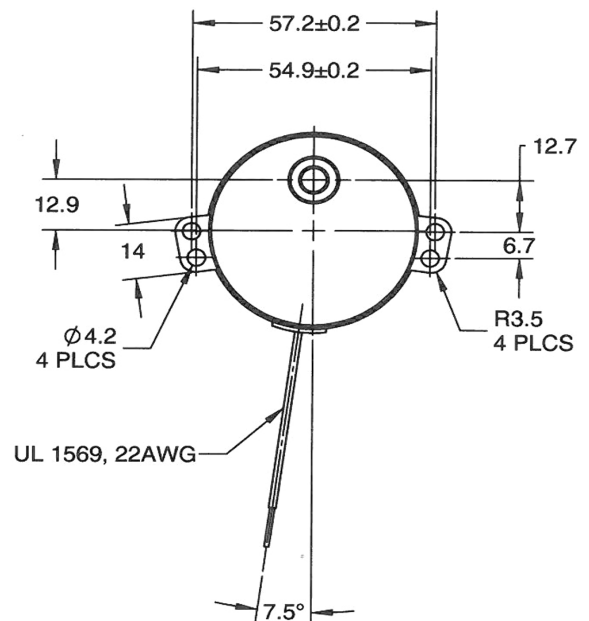
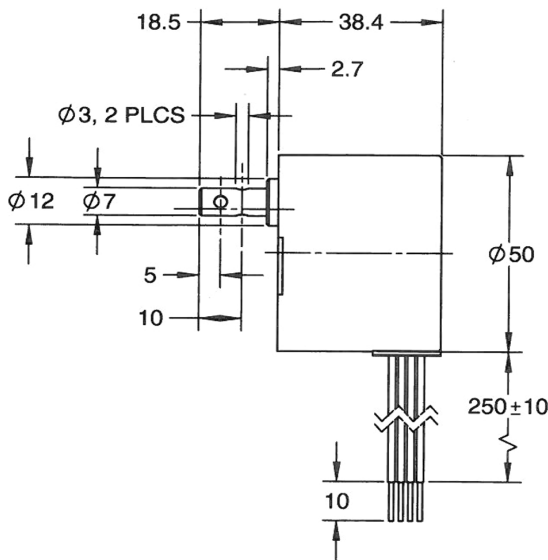

All units are in mm

L010511

| Model #                | Input Voltage (VAC) | Motor Speed (rpm) | Rated Torque (oz-in) | Capacitor |
|------------------------|---------------------|-------------------|----------------------|-----------|
| ACPMGM-050-038-110-001 | 110                 | 1.2               | 416                  | 0.56      |
| ACPMGM-050-038-110-002 | 110                 | 2                 | 347                  | 0.56      |
| ACPMGM-050-038-110-003 | 110                 | 3                 | 292                  | 0.56      |
| ACPMGM-050-038-110-004 | 110                 | 4                 | 250                  | 0.56      |
| ACPMGM-050-038-110-005 | 110                 | 4.8               | 208                  | 0.56      |
| ACPMGM-050-038-110-006 | 110                 | 6                 | 134                  | 0.56      |
| ACPMGM-050-038-110-008 | 110                 | 8                 | 104                  | 0.56      |
| ACPMGM-050-038-110-010 | 110                 | 10                | 86                   | 0.56      |
| ACPMGM-050-038-110-015 | 110                 | 15                | 64                   | 0.56      |
| ACPMGM-050-038-110-020 | 110                 | 20                | 49                   | 0.56      |
| ACPMGM-050-038-110-026 | 110                 | 26.7              | 42                   | 0.56      |
| ACPMGM-050-038-110-034 | 110                 | 34                | 28                   | 0.56      |
| ACPMGM-050-038-110-040 | 110                 | 40                | 24                   | 0.56      |
| ACPMGM-050-038-110-050 | 110                 | 50                | 19                   | 0.56      |
| ACPMGM-050-038-110-060 | 110                 | 60                | 16                   | 0.56      |
| ACPMGM-050-038-110-080 | 110                 | 80                | 11                   | 0.56      |
| ACPMGM-050-038-110-120 | 110                 | 120               | 7                    | 0.56      |
| ACPMGM-050-038-110-180 | 110                 | 180               | 5                    | 0.56      |
| ACPMGM-050-038-220-001 | 220                 | 1.2               | 416                  | 0.15      |
| ACPMGM-050-038-220-002 | 220                 | 2                 | 347                  | 0.15      |
| ACPMGM-050-038-220-003 | 220                 | 3                 | 292                  | 0.15      |
| ACPMGM-050-038-220-004 | 220                 | 4                 | 250                  | 0.15      |
| ACPMGM-050-038-220-005 | 220                 | 4.8               | 208                  | 0.15      |
| ACPMGM-050-038-220-006 | 220                 | 6                 | 134                  | 0.15      |
| ACPMGM-050-038-220-008 | 220                 | 8                 | 104                  | 0.15      |
| ACPMGM-050-038-220-010 | 220                 | 10                | 86                   | 0.15      |
| ACPMGM-050-038-220-015 | 220                 | 15                | 64                   | 0.15      |
| ACPMGM-050-038-220-020 | 220                 | 20                | 49                   | 0.15      |
| ACPMGM-050-038-220-026 | 220                 | 26.7              | 42                   | 0.15      |
| ACPMGM-050-038-220-034 | 220                 | 34                | 28                   | 0.15      |
| ACPMGM-050-038-220-040 | 220                 | 40                | 24                   | 0.15      |
| ACPMGM-050-038-220-050 | 220                 | 50                | 19                   | 0.15      |
| ACPMGM-050-038-220-060 | 220                 | 60                | 16                   | 0.15      |
| ACPMGM-050-038-220-080 | 220                 | 80                | 11                   | 0.15      |
| ACPMGM-050-038-220-120 | 220                 | 120               | 7                    | 0.15      |
| ACPMGM-050-038-220-180 | 220                 | 180               | 5                    | 0.15      |

|              |               |                   |              |
|--------------|---------------|-------------------|--------------|
| Noise Level: | 45 dB         | Phase:            | Single-phase |
| Frequency:   | 60 Hz         | Temperature Rise: | 60° C        |
| Rotation:    | Bidirectional |                   |              |

