

# BLWR11 Series - Brushless DC Motors



## FEATURES

- **Size 11 BLDC Motor**
- **Compact Size and Power Density**
- **Cost Effective Solution**
- **Long Life and Highly Reliable**
- **Can be Customized for**
  - Maximum Speed
  - Winding Current
  - Shaft Options
  - Cables and Connectors
- **CE Certified and RoHS Compliant**



## DESCRIPTION

The BLWR11 Series Brushless DC Motors come in a compact package with high power density. These motors are cost effective solutions to many velocity control applications. The star wound motor comes in a standard 8-lead configuration. We can also customize the winding to perfectly match your voltage, current, and maximum operating speed. Special shaft modifications, cables and connectors are also available upon request.

## SPECIFICATIONS

Model #	FRAME Size	Rated Voltage (V)	Rated Speed (RPM)	Rated Power (W)	Peak Torque (oz-in)	Peak Current (A)	Line to Line Resistance (ohms)	Line to Line Inductance (mH)	Torque Constant (oz-in/A)	Rotor Inertia (oz-in-sec <sup>2</sup> )	Weight (lbs)	"L" Length (in)
BLWR110S-15V-8000	Size 11	15	8,000	6	3	2.5	8	2	1.94	1.7x10 <sup>-5</sup>	0.15	1.0
BLWR111S-24V-10000	Size 11	24	10,000	15	6	2.8	4.6	1.69	2.26	3.0x10 <sup>-5</sup>	0.16	1.5
BLWR112S-24V-3700	Size 11	24	3,700	16	21	3	4.7	3.5	7.08	8.5x10 <sup>-5</sup>	0.42	3.0

Note: Other speed options, custom leadwires, cables, connectors, and windings are available upon request.

Winding Type:	Star, 4 Poles	Max. Radial Force:	15N @ 10mm from the flange
Hall Effect Angle:	120 degree electrical angle	Max. Axial Force:	10N
Shaft Run Out:	0.025mm	Insulation Class:	Class B
Radial Play:	0.02mm@450g	Dielectric Strength:	500VDC for one minute
End Play:	0.08mm@450g	Insulation Resistance:	100MOhm, 500VDC

L010234

(For 110's and 111's)

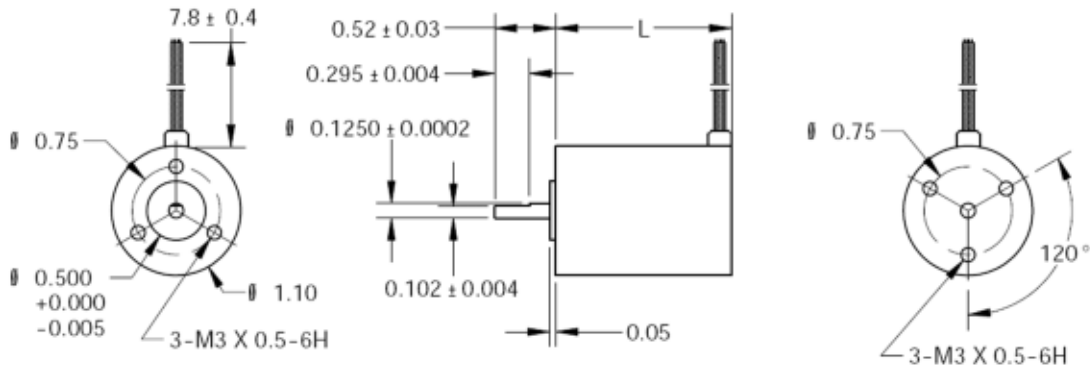

(Units in inches)

(For 112's)

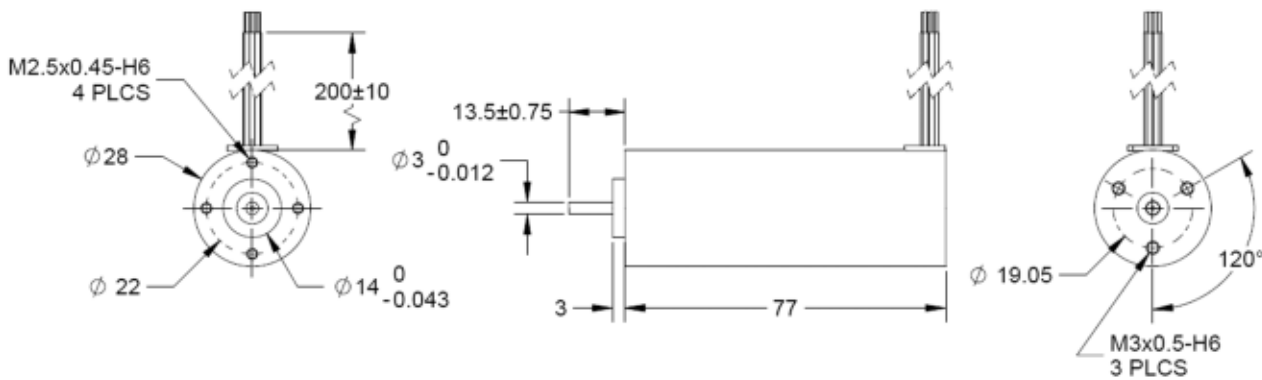

Dual Shaft

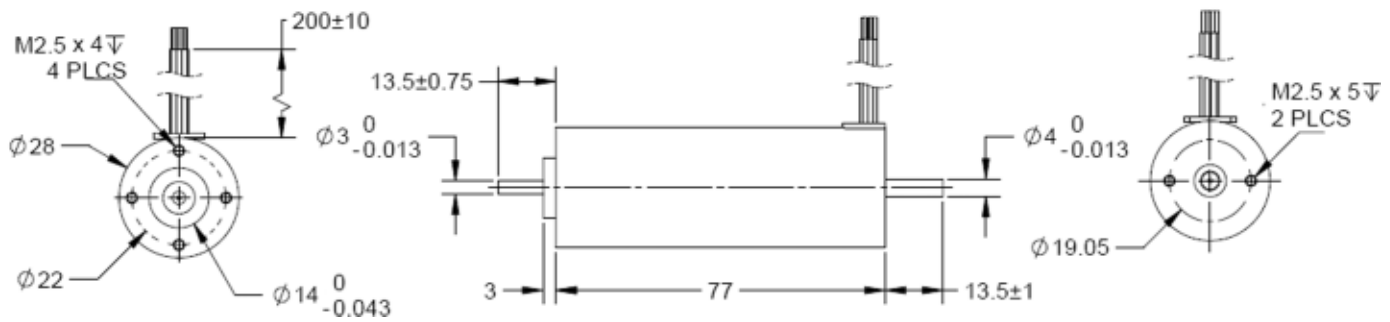

(All units are mm)

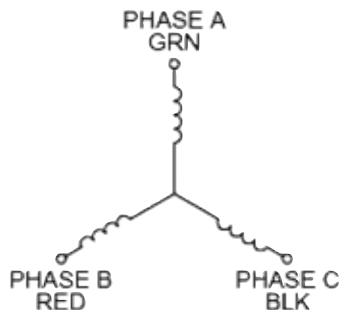

Description	Motor Wire Color	Cable Adder Color
Hall Supply	Yellow	Red/White
Hall A	Blue	Orange/White
Hall B	Orange	Orange
Hall C	Brown	Yellow/White
Hall Ground	White	Black/White
Phase A	Green	Yellow
Phase B	Red	Red
Phase C	Black	Black