

FEATURES

- **Integral Clamp Couplings**
- **High Quality Helical Design**
- **Aluminum Design**
- **Compensates for Shaft Misalignment**
- **No Backlash**
- **No Maintenance**
- **Wide Variety of Sizes**



The CPL-HC Series is a high-quality helical design coupling line. These cap screw clamp type couplings compensate for motor shaft misalignment, and operate at high speeds, transmitting high torque at a constant velocity, as well as compensating for lateral, axial, and angular misalignments. There is no backlash and the CPL-HC Series never requires maintenance. Offered in a variety of outside diameter sizes, major and minor bore diameters, the CPL-HC Series is capable of handling screw torque up to 25 ounce-inches.

DIMENSION

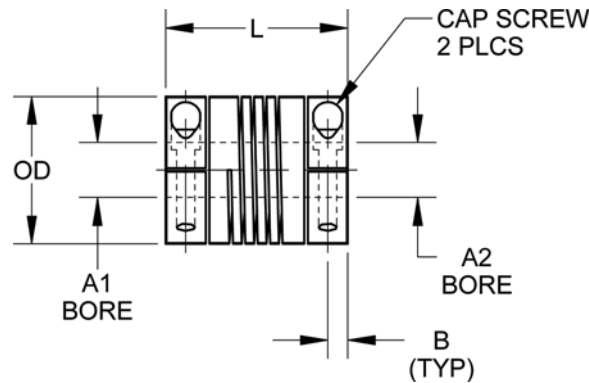

BUILD A PART NUMBER

Model #	Bore A1 (in)	Bore A2 (in)	Outside Diameter (in)	Torque (in-lb)	Length (in)	Dim A (in)	Dim B (in)	Screw Size	Screw Torque (in-lb)	Torsional Flexibility (deg/in-lb)	Inertia (lb-in-sec ²)	Weight (g)
CPL-HC050-125-125	0.125	0.125	0.5	3.5	0.75	0.19	0.1	1-72	4	1.34	1.09x10 ⁻⁶	5.8
CPL-HC075-4mm-4mm	0.157	0.157	0.75	9.1	0.9	0.25	0.13	4-40	13	0.48	6.45x10 ⁻⁶	15
CPL-HC075-5mm-5mm	0.197	0.197	0.75	9.1	0.9	0.25	0.13	4-40	13	0.48	6.45x10 ⁻⁶	15
CPL-HC075-250-250	0.25	0.25	0.75	8	0.9	0.25	0.13	4-40	13	0.74	6.45x10 ⁻⁶	15
CPL-HC100-250-250	0.25	0.25	1	21	1.25	0.31	0.15	6-32	25	0.2	2.89x10 ⁻⁶	38
CPL-HC100-8mm-8mm	0.315	0.315	1	19	1.25	0.31	0.15	6-32	25	0.28	2.89x10 ⁻⁶	38
CPL-HC100-375-375	0.375	0.375	1	17	1.25	0.31	0.15	6-32	25	0.39	2.89x10 ⁻⁶	38
CPL-HC112-375-375	0.375	0.375	1.125	30	1.5	0.45	0.15	6-32	25	0.19	5.36x10 ⁻⁵	54
CPL-HC112-500-500	0.5	0.5	1.125	23	1.5	0.45	0.15	6-32	25	0.35	5.36x10 ⁻⁵	54

L010558