

BDPG-16 Series



FEATURES

- **DC Brush Planetary Gearmotor**
- **Operates with 12V, 24V DC Input**
- **Designed for High Volume Applications**
- **Up to 33.33 oz-in of Continuous Torque**
- **16 mm Motor Body Diameter**
- **Custom Versions are Available**



DESCRIPTION

The BDPG 16 Series was designed for high volume OEM applications with low cost being the primary objective. These reliable low cost Brush DC Planetary Gearmotors come in a variety of power levels and sizes that will be sure to fit your needs. The motors are fully reversible. The BDPG 16 Series is a cost-effective solution to manage motion control in many rotary applications including medical, semiconductor, pumps, robotics, hobby, CNC, and many other applications where a low cost Brush DC Planetary Gearmotor is needed.

SPECIFICATIONS

Model #	Voltage (V)	Gear Ratio (X:1)	No Load Speed After Gearbox (RPM)	Efficiency (%)	Rated Speed (RPM)	Rated Torque (oz-in)	Peak Torque (oz-in)	Rated Current (mA)	No Load Current (mA)	Rated Output (W)	Weight (lbs)	Gearbox Length (L) (mm)
BDPG-16-27-12V-8000-R4	12	4	2000	80%	1330	0.29	1.5	≤ 85	≤ 50	0.39	0.08	15.05
BDPG-16-27-12V-8000-R14	12	14	571	70%	430	0.83	5.29	≤ 85	≤ 50	0.39	0.09	18.70
BDPG-16-27-12V-8000-R29	12	29	276	70%	205	1.7	10.95	≤ 85	≤ 50	0.39	0.09	18.70
BDPG-16-27-12V-8000-R62	12	62	129	60%	100	3.05	23.41	≤ 85	≤ 50	0.39	0.1	22.35
BDPG-16-27-12V-8000-R72	12	72	112	60%	85	3.61	27.19	≤ 85	≤ 50	0.39	0.1	22.35
BDPG-16-27-12V-8000-R128	12	128	62.5	60%	48	6.4	48.34	≤ 85	≤ 50	0.39	0.1	22.35
BDPG-16-27-12V-8000-R316	12	316	8000	50%	19	13.2	83.32	≤ 85	≤ 50	0.39	0.4	26.5
BDPG-16-27-12V-8000-R455	12	455	17.58	50%	13.5	18.8	83.32	≤ 85	≤ 50	0.39	0.1	26.00
BDPG-16-27-12V-8000-R690	12	690	11.6	50%	8.9	27.8	83.32	≤ 85	≤ 50	0.39	0.1	26.00
BDPG-16-27-12V-8000-R1621	12	1621	4.94	40%	3.8	33.33	100	≤ 85	≤ 50	0.39	0.11	29.65
BDPG-16-27-24V-13500-R4	24	4	3375	80%	2400	0.43	2.42	≤ 90	≤ 50	1.03	0.08	15.05
BDPG-16-27-24V-13500-R14	24	14	964	70%	760	1.18	8.48	≤ 90	≤ 50	1.03	0.09	18.70
BDPG-16-27-24V-13500-R29	24	29	466	70%	205	2.49	17.56	≤ 90	≤ 50	1.03	0.09	18.70
BDPG-16-27-24V-13500-R62	24	62	218	60%	170	4.58	38.15	≤ 90	≤ 50	1.03	0.1	22.35
BDPG-16-27-24V-13500-R72	24	72	188	60%	150	5.28	43.6	≤ 90	≤ 50	1.03	0.1	22.35
BDPG-16-27-24V-13500-R128	24	128	105	60%	85	9.58	66.66	≤ 90	≤ 50	1.03	0.1	22.35
BDPG-16-27-24V-13500-R316	24	316	13500	50%	34	19.4	83.32	≤ 90	≤ 50	1.03	0.4	38.6
BDPG-16-27-24V-13500-R455	24	455	29.67	50%	24	27.77	83.32	≤ 90	≤ 50	1.03	0.1	26.00
BDPG-16-27-24V-13500-R690	24	690	19.56	50%	15.9	33.33	83.32	≤ 90	≤ 50	1.03	0.1	26.00
BDPG-16-27-24V-13500-R1621	24	1621	8.33	40%	7.2	33.33	100	≤ 90	≤ 50	1.03	0.11	29.65

L011238

SPECIFICATIONS

Housing Material:	Metal	Radial Play of Shaft:	≤ 0.08 mm
Bearing at Output:	Sleeve Bearings	Radial Load (10mm from flange):	≤ 0.5 kgf
Humidity:	20%~85% RH	Shaft Axial Load:	≤ 0.5 kgf
Backlash at No Load:	≤ 3°	Shaft Press Fit Force, Max:	≤ 1.5 kgf
Operating Temperature:	-10°C~+60°C	Thrust Play of Shaft:	≤ 0.2 mm

Gearbox Ratio	Gearbox Length (L) (mm)
1:4, 1:5	15.05
1:14, 1:19, 1:29	18.70
1:62, 1:72, 1:84, 1:104, 1:128, 1:157	22.35
1:231, 1:316, 1:370, 1:456, 1:561, 1:690	26.00
1:1014, 1:1621, 1:1996, 1:3027	29.65

DIMENSIONS

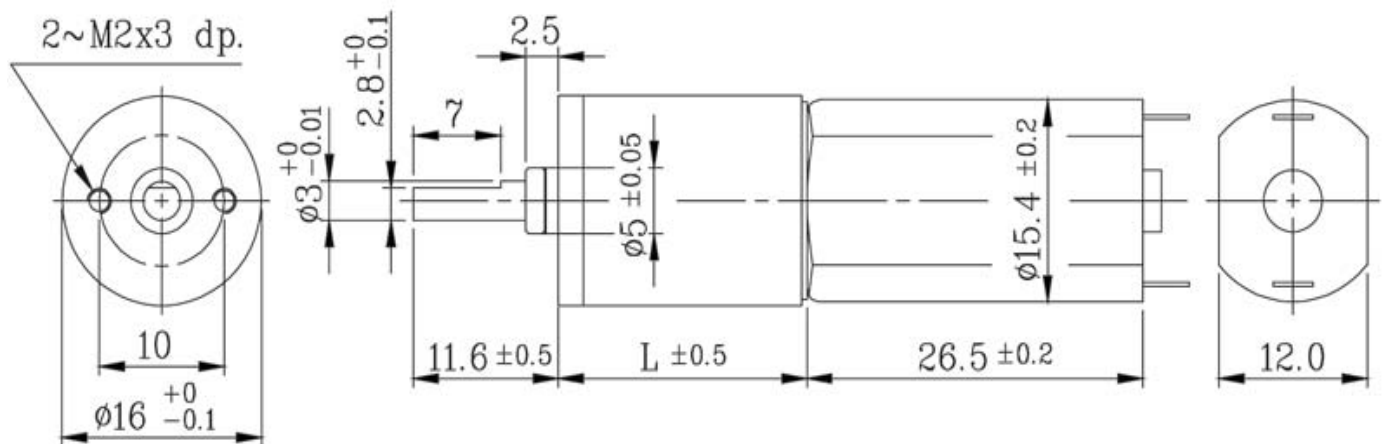

* Dimensions are in mm