

# CPC-HR15 - Linear Guides

DIMENSIONS

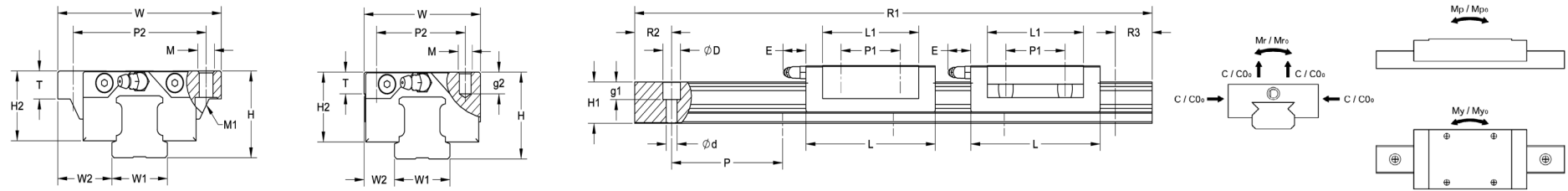

SPECIFICATIONS

Block Part Number	Fabrication Dimensions (mm)		Block Dimensions (mm)										Load Capacities (kN)			Static Moment (Nm)			Weight (lbs)
	H	W <sub>2</sub>	W	L	L1	h2	P1	P2	E	Mxg2	M1	T	C	C <sub>0</sub>	M <sub>r0</sub>	M <sub>p0</sub>	M <sub>y0</sub>		
CPC-HR15MNSZV0N	28	9.5	34	56.1	39.5	24.1	26	26	10	M4x7		6	9	17.5	140	100	100	0.4	
CPC-HR15FNSZV0N	24	16	47	56.1	39.5	20.1	30	38	12	M5x9	-	10	9	17.5	140	100	100	0.4	
CPC-HR15MNBZV0n	28	9.5	34	56.1	39.5	24.1	26	36	10	M4x7	-	6	9	17.5	140	100	100	0.4	

Rail Part Number	Rail Dimensions (mm)									Weight (lbs)
	W <sub>1</sub>	H <sub>1</sub>	P	D	d <sub>1</sub>	g <sub>1</sub>	R <sub>1</sub>	R <sub>2</sub>	R <sub>3</sub>	
CPC-AR15N-0100-20-20	15	15	60	8	4	5	100	20	20	0.3
CPC-AR15N-0300-30-30	15	15	60	8	4	5	300	30	30	0.9
CPC-AR15N-0500-10-10	15	15	60	8	4	5	500	10	10	1.4
CPC-AR15N-0700-20-20	15	15	60	8	4	5	700	20	20	2.0
CPC-AR15N-0900-30-30	15	15	60	8	4	5	900	30	30	2.6
CPC-AR15N-1100-10-10	15	15	60	8	4	5	1100	10	10	3.1
CPC-AR15N-1300-20-20	15	15	60	8	4	5	1300	20	20	3.7
CPC-AR15N-1500-30-30	15	15	60	8	4	5	1500	30	30	4.3
CPC-AR15N-1700-10-10	15	15	60	8	4	5	1700	10	10	4.8
CPC-AR15N-1900-20-20	15	15	60	8	4	5	1900	20	20	5.4
CPC-AR15N-2100-30-30	15	15	60	8	4	5	2100	30	30	6.0
CPC-AR15N-2300-10-10	15	15	60	8	4	5	2300	10	10	6.5
CPC-AR15N-2500-20-20	15	15	60	8	4	5	2500	20	20	7.1
CPC-AR15N-2700-30-30	15	15	60	8	4	5	2700	30	30	7.7
CPC-AR15N-2900-10-10	15	15	60	8	4	5	2900	10	10	8.2
CPC-AR15N-3100-20-20	15	15	60	8	4	5	3100	20	20	8.8
CPC-AR15N-3300-30-30	15	15	60	8	4	5	3300	30	30	9.4
CPC-AR15N-3500-10-10	15	15	60	8	4	5	3500	10	10	9.9
CPC-AR15N-3700-20-20	15	15	60	8	4	5	3700	20	20	10.5
CPC-AR15N-3900-30-30	15	15	60	8	4	5	3900	30	30	11.1
CPC-AR15N-4000L	15	15	60	8	4	5	4000	30	30	11.4

The rated load capacities and static moment values are calculated according to the ISO14728 standard. The rated life for basic dynamic load is defined as the total 100km travel distance that 90% of a group of identical linear guides can be operated individually under the same conditions, free from any material damage caused by rolling fatigue-When the standard of 50km travel distance is applied. The basic dynamic load rating C of ISO14728 should be multiplied by 1.26 for conversion.

Distributed by Anaheim Automation, Inc.  
 USA Stock in Anaheim, CA  
 1-800-345-9401  
[www.anaheimautomation.com](http://www.anaheimautomation.com)