

CPC-MR9 - Miniature Linear Guides

DIMENSIONS

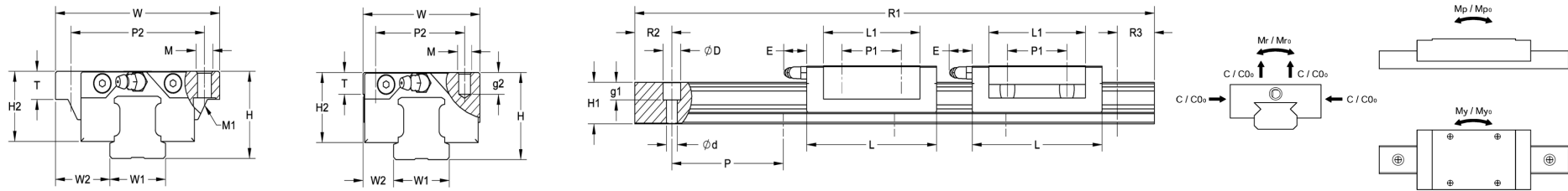

SPECIFICATIONS

Part Number	Fabrication Dimensions (mm)		Block Dimensions (mm)											Rail Dimension (mm)					Load Capacities (kN)		Static Moment (Nm)			Block Weight (lbs)	Rail Weight (lbs)
	H	W ₂	W	L	L ₁	h ₂	P	P ₁	P ₂	D x d x g ₁	M x g ₂	S	T	W ₁	H ₁	R ₁	R ₂	R ₃	C	C ₀	M _{r0}	M _{p0}	M _{y0}		
CPC-MR9MLSSV0N-100-10-10	10	5.5	20	41.1	30.8	8	20	16	15	6 x 3.5 x 3.5	M3 x 3.0	2.2	3.3	9	5.5	100	10	10	2.135	3.88	18.2	12.4	12.4	0.06	0.07
CPC-MR9MLSSV0N-300-10-10	10	5.5	20	41.1	30.8	8	20	16	15	6 x 3.5 x 3.5	M3 x 3.0	2.2	3.3	9	5.5	300	10	10	2.135	3.88	18.2	12.4	12.4	0.06	0.13
CPC-MR9MLSSV0N-500-10-10	10	5.5	20	41.1	30.8	8	20	16	15	6 x 3.5 x 3.5	M3 x 3.0	2.2	3.3	9	5.5	500	10	10	2.135	3.88	18.2	12.4	12.4	0.06	0.33
CPC-MR9MLSSV0N-780-10-10	10	5.5	20	41.1	30.8	8	20	16	15	6 x 3.5 x 3.5	M3 x 3.0	2.2	3.3	9	5.5	780	10	10	2.135	3.88	18.2	12.4	12.4	0.06	0.52
CPC-MR9MLSSV0N-1000L	10	5.5	20	41.1	30.8	8	20	16	15	6 x 3.5 x 3.5	M3 x 3.0	2.2	3.3	9	5.5	1000	10	10	2.135	3.88	18.2	12.4	12.4	0.06	0.66
CPC-MR9MNSSV0N-100-10-10	10	5.5	20	30.9	20.5	7.9	20	10	15	6 x 3.5 x 3.5	M3 x 3.0	2.2	3.3	9	5.5	100	10	10	1.57	2.495	11.7	6.4	6.4	0.04	0.07
CPC-MR9MNSSV0N-300-10-10	10	5.5	20	30.9	20.5	7.9	20	10	15	6 x 3.5 x 3.5	M3 x 3.0	2.2	3.3	9	5.5	300	10	10	1.57	2.495	11.7	6.4	6.4	0.04	0.13
CPC-MR9MNSSV0N-500-10-10	10	5.5	20	30.9	20.5	7.9	20	10	15	6 x 3.5 x 3.5	M3 x 3.0	2.2	3.3	9	5.5	500	10	10	1.57	2.495	11.7	6.4	6.4	0.04	0.33
CPC-MR9MNSSV0N-780-10-10	10	5.5	20	30.9	20.5	7.9	20	10	15	6 x 3.5 x 3.5	M3 x 3.0	2.2	3.3	9	5.5	780	10	10	1.57	2.495	11.7	6.4	6.4	0.04	0.52
CPC-MR9MNSSV0N-1000L	10	5.5	20	30.9	20.5	7.9	20	10	15	6 x 3.5 x 3.5	M3 x 3.0	2.2	3.3	9	5.2	1000	10	10	1.57	2.495	11.7	6.4	6.4	0.04	0.66
CPC-MR9WLSSV0N-100-5-5	12	6	30	50.8	39.4	8.8	30	24	23	6 x 3.5 x 4.5	M3 x 3	2.6	4	18	5.2	100	5	5	2.55	4.99	45.9	26.7	26.7	0.11	0.21
CPC-MR9WLSSV0N-300-15-15	12	6	30	50.8	39.4	8.8	30	24	23	6 x 3.5 x 4.5	M3 x 3	2.6	4	18	5.2	300	15	15	2.55	4.99	45.9	26.7	26.7	0.11	0.62
CPC-MR9WLSSV0N-500-10-10	12	6	30	50.8	39.4	8.8	30	24	23	6 x 3.5 x 4.5	M3 x 3	2.6	4	18	5.2	500	10	10	2.55	4.99	45.9	26.7	26.7	0.11	1.04
CPC-MR9WLSSV0N-780-15-15	12	6	30	50.8	39.4	8.8	30	24	23	6 x 3.5 x 4.5	M3 x 3	2.6	4	18	5.2	780	15	15	2.55	4.99	45.9	26.7	26.7	0.11	1.61
CPC-MR9WLSSV0N-1000L	12	6	30	50.8	39.4	8.8	30	24	23	6 x 3.5 x 4.5	M3 x 3	2.6	4	18	5.2	1000	10	10	2.55	4.99	45.9	26.7	26.7	0.11	2.07
CPC-MR9WNSSV0N-100-5-5	12	6	30	39.4	27.9	8.9	30	12	21	6 x 3.5 x 4.5	M3 x 3	2.6	4	18	5.2	100	5	5	2.03	3.605	33.2	13.7	13.7	0.08	0.21
CPC-MR9WNSSV0N-300-15-15	12	6	30	39.4	27.9	8.9	30	12	21	6 x 3.5 x 4.5	M3 x 3	2.6	4	18	5.2	300	15	15	2.03	3.605	33.2	13.7	13.7	0.08	0.62
CPC-MR9WNSSV0N-500-10-10	12	6	30	39.4	27.9	8.9	30	12	21	6 x 3.5 x 4.5	M3 x 3	2.6	4	18	5.2	500	10	10	2.03	3.605	33.2	13.7	13.7	0.08	1.04
CPC-MR9WNSSV0N-780-15-15	12	6	30	39.4	27.9	8.9	30	12	21	6 x 3.5 x 4.5	M3 x 3	2.6	4	18	5.2	780	15	15	2.03	3.605	33.2	13.7	13.7	0.08	1.61
CPC-MR9WNSSV0N-1000L	12	6	30	39.4	27.9	8.9	30	12	21	6 x 3.5 x 4.5	M3 x 3	2.6	4	18	5.2	1000	10	10	2.03	3.605	33.2	13.7	13.7	0.08	2.07

The rated load capacities and static moment values are calculated according to the ISO14728 standard. The rated life for basic dynamic load is defined as the total 100km travel distance that 90% of a group of identical linear guides can be operated individually under the same conditions, free from any material damage caused by rolling fatigue. When the standard of 50km travel distance is applied. The basic dynamic load rating C of ISO14728 should be multiplied by 1.26 for conversion.

Distributed by Anaheim Automation, Inc.
 USA Stock in Anaheim, CA
 1-800-345-9401
www.anaheimautomation.com

CPC-MR9 - Miniature Linear Guides

DIMENSIONS

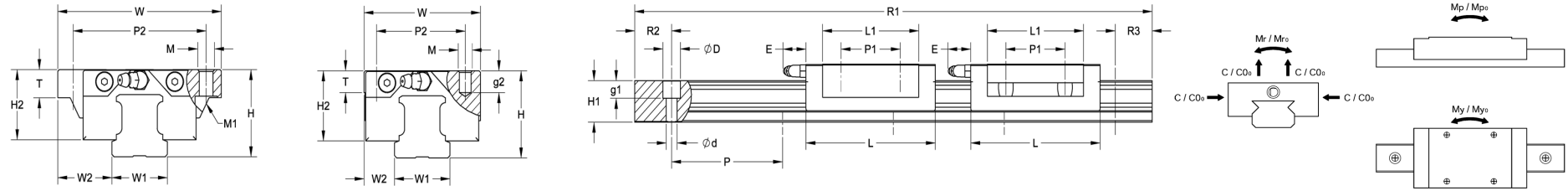

SPECIFICATIONS

Part Number	Fabrication Dimensions (mm)		Block Dimensions (mm)											Rail Dimension (mm)					Load Capacities (kN)		Static Moment (Nm)			Block Weight (lbs)	Rail Weight (lbs)
	H	W ₂	W	L	L ₁	h ₂	P	P ₁	P ₂	D x d x g ₁	M x g ₂	S	T	W ₁	H ₁	R ₁	R ₂	R ₃	C	C ₀	Mr ₀	Mp ₀	My ₀		
CPC-MR9MLSUV0N-100-10-10	10	5.5	20	41.1	30.8	8.2	20	16	15	6 x 3.5 x 3.5	M3 x 3.0	2.2	3.3	9	5.5	100	10	10	2.135	3.88	18.2	12.4	12.4	0.06	0.07
CPC-MR9MLSUV0N-300-10-10	10	5.5	20	41.1	30.8	8.2	20	16	15	6 x 3.5 x 3.5	M3 x 3.0	2.2	3.3	9	5.5	300	10	10	2.135	3.88	18.2	12.4	12.4	0.06	0.13
CPC-MR9MLSUV0N-500-10-10	10	5.5	20	41.1	30.8	8.2	20	16	15	6 x 3.5 x 3.5	M3 x 3.0	2.2	3.3	9	5.5	500	10	10	2.135	3.88	18.2	12.4	12.4	0.06	0.33
CPC-MR9MLSUV0N-780-10-10	10	5.5	20	41.1	30.8	8.2	20	16	15	6 x 3.5 x 3.5	M3 x 3.0	2.2	3.3	9	5.5	780	10	10	2.135	3.88	18.2	12.4	12.4	0.06	0.52
CPC-MR9MLSUV0N-1000L	10	5.5	20	41.1	30.8	8.2	20	16	15	6 x 3.5 x 3.5	M3 x 3.0	2.2	3.3	9	5.5	1000	10	10	2.135	3.88	18.2	12.4	12.4	0.06	0.66
CPC-MR9MNSUV0N-100-10-10	10	5.5	20	30.8	20.5	8.0	20	10	15	6 x 3.5 x 3.5	M3 x 3.0	2.2	3.3	9	5.5	100	10	10	1.57	2.495	11.7	6.4	6.4	0.04	0.07
CPC-MR9MNSUV0N-300-10-10	10	5.5	20	30.8	20.5	8.0	20	10	15	6 x 3.5 x 3.5	M3 x 3.0	2.2	3.3	9	5.5	300	10	10	1.57	2.495	11.7	6.4	6.4	0.04	0.13
CPC-MR9MNSUV0N-500-10-10	10	5.5	20	30.8	20.5	8.0	20	10	15	6 x 3.5 x 3.5	M3 x 3.0	2.2	3.3	9	5.5	500	10	10	1.57	2.495	11.7	6.4	6.4	0.04	0.33
CPC-MR9MNSUV0N-780-10-10	10	5.5	20	30.8	20.5	8.0	20	10	15	6 x 3.5 x 3.5	M3 x 3.0	2.2	3.3	9	5.5	780	10	10	1.57	2.495	11.7	6.4	6.4	0.04	0.52
CPC-MR9MNSUV0N-1000L	10	5.5	20	30.8	20.5	8.0	20	10	15	6 x 3.5 x 3.5	M3 x 3.0	2.2	3.3	9	5.2	1000	10	10	1.57	2.495	11.7	6.4	6.4	0.04	0.66
CPC-MR9WLSUV0N-040-5-5	12	6	30	51	39.5	9	30	24	23	6 x 3.5 x 4.5	M3 x 3	2.6	4	18	5.2	40	5	5	2.55	4.99	45.9	26.7	26.7	0.11	0.08
CPC-MR9WLSUV0N-100-5-5	12	6	30	51	39.5	9	30	24	23	6 x 3.5 x 4.5	M3 x 3	2.6	4	18	5.2	100	5	5	2.55	4.99	45.9	26.7	26.7	0.11	0.21
CPC-MR9WLSUV0N-300-15-15	12	6	30	51	39.5	9	30	24	23	6 x 3.5 x 4.5	M3 x 3	2.6	4	18	5.2	300	15	15	2.55	4.99	45.9	26.7	26.7	0.11	0.62
CPC-MR9WLSUV0N-500-10-10	12	6	30	51	39.5	9	30	24	23	6 x 3.5 x 4.5	M3 x 3	2.6	4	18	5.2	500	10	10	2.55	4.99	45.9	26.7	26.7	0.11	1.04
CPC-MR9WLSUV0N-780-15-15	12	6	30	51	39.5	9	30	24	23	6 x 3.5 x 4.5	M3 x 3	2.6	4	18	5.2	780	15	15	2.55	4.99	45.9	26.7	26.7	0.11	1.61
CPC-MR9WLSUV0N-1000L	12	6	30	51	39.5	9	30	24	23	6 x 3.5 x 4.5	M3 x 3	2.6	4	18	5.2	1000	10	10	2.55	4.99	45.9	26.7	26.7	0.11	2.07
CPC-MR9WNSUV0N-100-5-5	12	6	30	39.4	27.9	9.1	30	12	21	6 x 3.5 x 4.5	M3 x 3	2.6	4	18	5.2	100	5	5	2.03	3.605	33.2	13.7	13.7	0.08	0.21
CPC-MR9WNSUV0N-300-15-15	12	6	30	39.4	27.9	9.1	30	12	21	6 x 3.5 x 4.5	M3 x 3	2.6	4	18	5.2	300	15	15	2.03	3.605	33.2	13.7	13.7	0.08	0.62
CPC-MR9WNSUV0N-500-10-10	12	6	30	39.4	27.9	9.1	30	12	21	6 x 3.5 x 4.5	M3 x 3	2.6	4	18	5.2	500	10	10	2.03	3.605	33.2	13.7	13.7	0.08	1.04
CPC-MR9WNSUV0N-780-15-15	12	6	30	39.4	27.9	9.1	30	12	21	6 x 3.5 x 4.5	M3 x 3	2.6	4	18	5.2	780	15	15	2.03	3.605	33.2	13.7	13.7	0.08	1.61
CPC-MR9WNSUV0N-1000L	12	6	30	39.4	27.9	9.1	30	12	21	6 x 3.5 x 4.5	M3 x 3	2.6	4	18	5.2	1000	10	10	2.03	3.605	33.2	13.7	13.7	0.08	2.07

The rated load capacities and static moment values are calculated according to the ISO14728 standard. The rated life for basic dynamic load is defined as the total 100km travel distance that 90% of a group of identical linear guides can be operated individually under the same conditions, free from any material damage caused by rolling fatigue-When the standard of 50km travel distance is applied. The basic dynamic load rating C of ISO14728 should be multiplied by 1.26 for conversion.

Distributed by Anaheim Automation, Inc.
 USA Stock in Anaheim, CA
 1-800-345-9401
 www.anaheimautomation.com