

NSK-RA65 - Linear Guides

DIMENSIONS

Rail Part Number	Rail Dimensions (mm)							Weight (lbs)
	W ₁	H ₁	G	F	d x D x h	B ₃	Rail Length (mm)	
NSK-R1A65L-200-25-25	63	55	35	75	18x26x22	31.5	9.7	6.4
NSK-R1A65L-400-12.5-12.5	63	55	35	75	18x26x22	31.5	19.4	12.9
NSK-R1A65L-500-25-25	63	55	35	75	18x26x22	31.5	24.3	16.1
NSK-R1A65L-700-12.5-12.5	63	55	35	75	18x26x22	31.5	34.0	22.5
NSK-R1A65L-800-25-25	63	55	35	75	18x26x22	31.5	38.8	25.8
NSK-R1A65L-1000-12.5-12.5	63	55	35	75	18x26x22	31.5	48.5	32.2
NSK-R1A65L-1100-25-25	63	55	35	75	18x26x22	31.5	53.4	35.4
NSK-R1A65L-1300-12.5-12.5	63	55	35	75	18x26x22	31.5	63.1	41.9
NSK-R1A65L-1400-25-25	63	55	35	75	18x26x22	31.5	67.9	45.1
NSK-R1A65L-1600-12.5-12.5	63	55	35	75	18x26x22	31.5	77.6	51.5
NSK-R1A65L-1700-25-25	63	55	35	75	18x26x22	31.5	82.5	54.7
NSK-R1A65L-1900-12.5-12.5	63	55	35	75	18x26x22	31.5	92.2	61.2
NSK-R1A65L-2000-25-25	63	55	35	75	18x26x22	31.5	97.0	64.4
NSK-R1A65L-2200-12.5-12.5	63	55	35	75	18x26x22	31.5	106.7	70.8
NSK-R1A65L-2300-25-25	63	55	35	75	18x26x22	31.5	111.6	74.0
NSK-R1A65L-2500-12.5-12.5	63	55	35	75	18x26x22	31.5	121.3	80.5
NSK-R1A65L-2600-25-25	63	55	35	75	18x26x22	31.5	126.1	83.7
NSK-R1A65L-2800-12.5-12.5	63	55	35	75	18x26x22	31.5	135.8	90.1
NSK-R1A65L-2900-25-25	63	55	35	75	18x26x22	31.5	140.7	93.4
NSK-R1A65L-3100-12.5-12.5	63	55	35	75	18x26x22	31.5	150.4	99.8
NSK-R1A65L-3200-25-25	63	55	35	75	18x26x22	31.5	155.2	103.0
NSK-R1A65L-3400-12.5-12.5	63	55	35	75	18x26x22	31.5	164.9	109.5
NSK-R1A65L-3500L	63	55	35	75	18x26x22	31.5	169.8	112.7

AN, AL Square Type

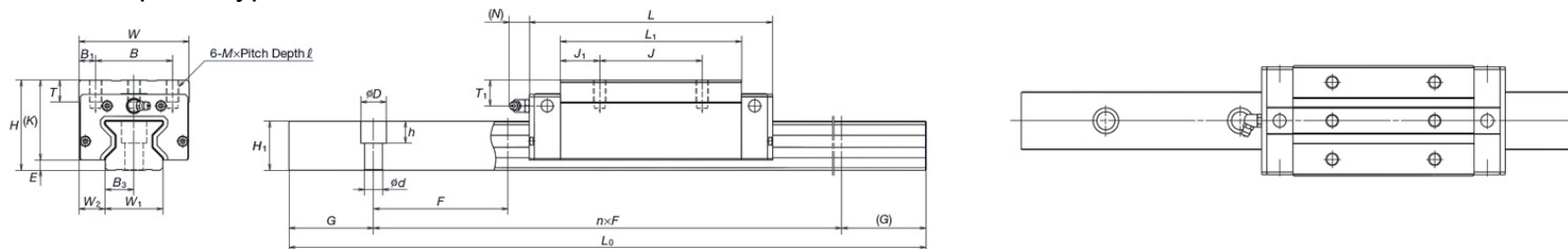

Block Part Number	Fabrication Dimension (mm)		Block Dimensions (mm)											Load Capacities (kN)		Static Moment (Nm)			Weight (lbs)	
	H	W ₂	W	L	L1	B	B1	E	J1	T1	N	J	K	T	C	C ₀	Mr ₀	Mp ₀		My ₀
NSK-RAA55ANP6Z	80	23.5	100	184	128	76	25	9	26.5	21	14	75	71	18	129	330	10200	7060	7060	20.50

The rated load capacities and static moment values are calculated according to the ISO Standards (ISO14728-1) for linear guides. If the above basic dynamic load rating (100km) is converted into 50km rating, use the formula:
 $C_{50km} = 1.23 \times C_{100km}$. With the RA series, the dynamic load rating is the same in both the vertical and horizontal directions (4-way load specifications).

Distributed by Anaheim Automation, Inc.
 USA Stock in Anaheim, CA
 1-800-345-9401
www.anaheimautomation.com

BN, BL, Low-Profile Type

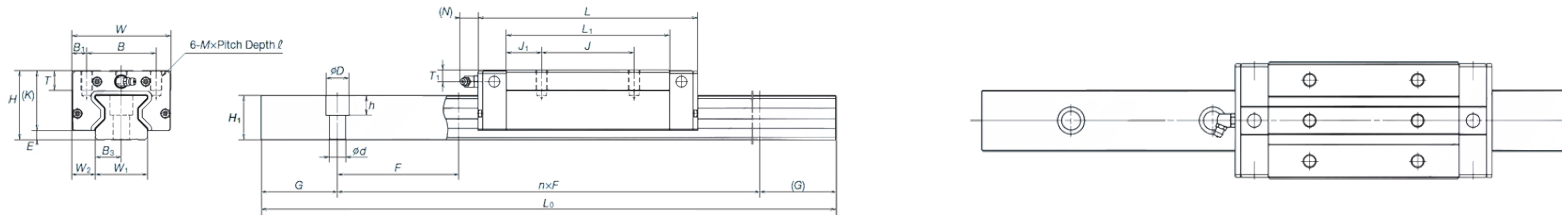

Block Part Number	Fabrication Dimension (mm)		Block Dimensions (mm)											Load Capacities (kN)		Static Moment (Nm)			Weight (lbs)	
	H	W ₂	W	L	L ₁	B	B ₁	E	J ₁	T ₁	N	J	K	T	C	C ₀	Mr ₀	Mp ₀		My ₀
NSK-RAA65BNP6Z	90	31.5	126	302.5	229.5	76	25	13	54.75	19	14	120	77	22	288	756	28700	28600	28600	26.90

EM, GM Flange Type

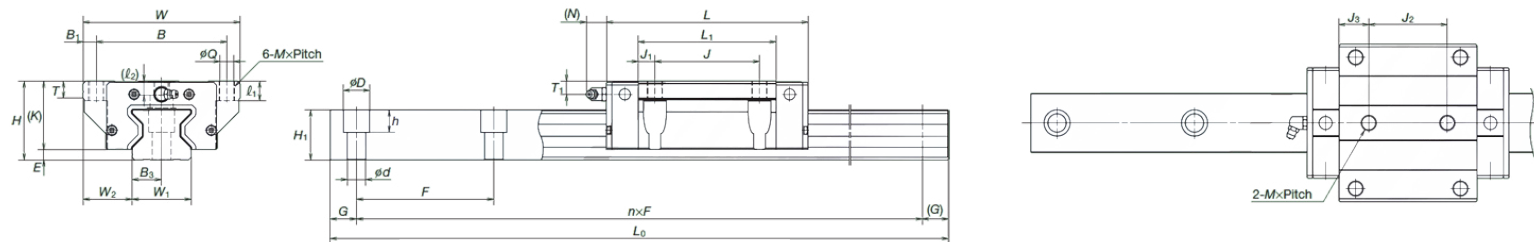

Block Part Number	Fabrication Dimension (mm)		Block Dimensions (mm)											Load Capacities (kN)		Static Moment (Nm)			Weight (lbs)	
	H	W ₂	W	L	L ₁	B	B ₁	E	J ₁	T ₁	N	J	K	T	C	C _n	Mr _n	Mp _n		My _n
NSK-RAA65EMP6Z	90	53.5	170	228.4	155.4	142	14	13	22.7	19	14	110	77	22	210	504	19200	12700	12700	26.90
NSK-RAA65GMP6Z	90	53.5	170	302.5	229.5	142	14	13	59.75	19	14	110	77	22	288	756	28700	28600	28600	36.38